

Conduit bodies and covers

Overview

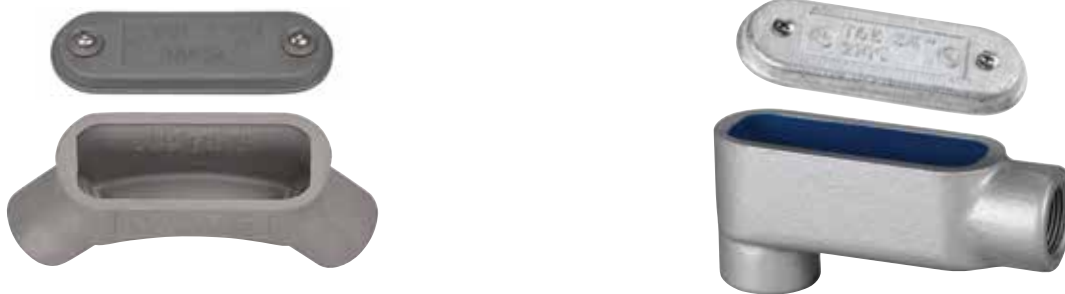

Application

Conduit bodies are installed in conduit systems to:

- Connect conduit sections
- Act as pull outlets when conductors are being installed
- Provide easy access for splices in branch conductors
- Make 90° bends in conduit runs
- Provide access to conductors for maintenance and future system changes

Features

- Standard features include tapered (NPT) threads and integral bushings to protect wire insulation
- T&B Fittings form 7 bodies and covers are interchangeable with other manufacturers' form 7 bodies and covers
- T&B Fittings form 8 bodies and covers are interchangeable with other manufacturers' Form 8 bodies and covers
- T&B Fittings form 9 bodies and covers are interchangeable with other manufacturers' Form 9 bodies and covers (Mark 9, FM 9)
- T&B Fittings form 7 and form 8 cast iron bodies feature BlueKote® internal coating for easier wire pulling
- Form 9 aluminum sand-cast copper-free aluminum alloy
- T&B Fittings series 35 bodies and covers are interchangeable with other manufacturers' 35/5 series iron and steel bodies and covers
- Form 7 sand cast aluminum is made with a special aluminum alloy, providing superior corrosion resistance as cast; no protective coatings needed
- Special sand cast aluminum alloy makes these conduit bodies ideal for use in food and beverage, pharmaceutical, chemical processing and other corrosive environments
- All form 7 and form 8 covers include gaskets

Materials

- Form 7, form 8 and series 35 iron conduit bodies: Sand-cast class 30 gray iron alloy
- Form 9 aluminum: Sand-cast copper-free aluminum alloy
- Stainless steel conduit bodies: Type 316 stainless steel
- Form 7 aluminum: Sand-cast CorroStall™ aluminum alloy
- Covers: Sand-cast gray iron alloy and stamped sheet steel with steel-stainless steel screws
- Stainless steel covers: Stamped type 316 stainless steel with stainless steel screws
- Gaskets: Neoprene
- Aluminum covers: Sand-cast CorroStall aluminum alloy or sheet aluminum with stainless steel screws, aluminum clips and stainless steel and neoprene O-ring washer

Finish

- Form 7, form 8 and series 35 iron conduit bodies: Zinc-plating with aluminum acrylic coating
- Form 7 and form 8 iron bodies: Internal PTFE-based BlueKote coating
- Covers: Gray iron zinc-plating with aluminum acrylic coating, and stamped steel zinc-plating with clear chromate coating; form 7 and form 8 covers include neoprene gasket
- Form 9 aluminum covers: Stamped copper-free aluminum sheet with stainless steel screws
- Stainless steel bodies and covers: Polished
- Aluminum bodies and covers: As cast/natural

Listings/compliances

- UL Standard: 514A, 514B
- Fed. Spec: W-C-586D
- CSA Standard: C22.2 No. 18

Conduit bodies and covers

Quick reference

Conduit bodies quick reference



Shape	Type	Hub size (in.)									
		½	¾	1	1¼	1½	2	2½	3	3½	4
	BlueKote® form 7	LB17	LB27	LB37	LB47	LB57	LB67	LB77	LB87	LB97	LB107
	BlueKote form 8*	LB18	LB28	LB38	LB448	LB58	LB68	LB78	LB888	LB98	LB108
	Series 35	LB50M	LB75M-TB	LB100M	LB125M	LB150M	LB200M	LB250M	LB300M	LB350M	LB400M
	Sand cast aluminum form 7	LB17SA	LB27SA	LB37SA	LB47SA	LB57SA	LB67SA	LB77SA	LB87SA	LB97SA	LB107SA
	Sand cast aluminum form 9	LB19SA	LB29SA	LB39SA	LB49SA	LB59SA	LB69SA	LB789SA	LB889SA	LB989SA	LB1089SA
	Stainless steel form 8**	LB18SST	LB28SST	LB38SST	LB48SST	LB58SST	LB68SST	-	-	-	-
	BlueKote form 7	LU17	LU27	LU37	LU47	LU57	LU67	-	-	-	-
	Sand cast aluminum form 7	LU17SA	LU27SA	LU37SA	LU47SA	LU57SA	LU67SA	-	-	-	-
	Sand cast aluminum form 9	LU19SA	LU29SA	LU39SA	LU49SA	LU59SA	LU69SA	-	-	-	-
	Stainless steel form 8**	LU18SST	LU28SST	LU38SST	LU48SST	LU58SST	LU68SST	-	-	-	-
	BlueKote form 7	T17	T27	T37	T47	T57	T67	T77	T87	T97	T107
	BlueKote form 8*	T18	T28	T38-TB	T448	T58	T68	T78	T88-TB	-	-
	Series 35	T50M	T75M	T100M	T125M	T150M	T200M	T250M	T300M	T350M	T400M
	Sand cast aluminum form 7	T17SA	T27SA	T37SA	T47SA	T57SA	T67SA	T77SA	T87SA	T97SA	T107SA
	Sand cast aluminum form 9	T19SA	T29SA	T39SA	T49SA	T59SA	T69SA	T789SA	T889SA	T989SA	T1089SA
	Stainless steel form 8**	T18SST	T28SST	T38SST	T48SST	T58SST	T68SST	-	-	-	-
	BlueKote form 7	C17	C27	C37	C47	C57	C67	C77-TB	C87	-	-
	BlueKote form 8*	C18	C28	C38	C448	C58-TB	C68	C78	C88	-	-
	Series 35	C50M	C75M-TB	C100M	C125M	C150M	C200M	C250M-TB	C300M	C350M	C400M
	Sand cast aluminum form 7	C17SA	C27SA	C37SA	C47SA	C57SA	C67SA	-	-	-	-
	Sand cast aluminum form 9	C19SA	C29SA	C39SA	C49SA	C59SA	C69SA	C789SA	C889SA	C989SA	C1089SA
	Stainless steel form 8**	C18SST	C28SST	C38SST	C48SST	C58SST	C68SST	-	-	-	-
	BlueKote form 7	LL17	LL27	LL37	LL47	LL57	LL67	LL77	LL87	LL97	LL107
	BlueKote form 8*	LL18	LL28	LL38	LL448	LL58	LL68	LL78	LL888	-	-
	Series 35	LL50M	LL75M	LL100M	LL125M	LL150M	LL200M	LL250M	LL300M	LL350M	LL400M
	Sand cast aluminum form 7	LL17SA	LL27SA	LL37SA	LL47SA	LL57SA	LL67SA	-	-	-	-
	Sand cast aluminum form 9	LL19SA	LL29SA	LL39SA	LL49SA	LL59SA	LL69SA	LL789SA	LL889SA	LL989SA	LL1089SA
	Stainless steel form 8**	LL18SST	LL28SST	LL38SST	LL48SST	LL58SST	LL68SST	-	-	-	-

* ½" through 1¼" have (2) mounting holes; 1½" through 4" have (4) mounting holes

** With covers, gaskets and screws

Conduit bodies and covers

Quick reference

Conduit bodies quick reference (continued)



Shape	Type	Hub size (in.)									
		½	¾	1	1¼	1½	2	2½	3	3½	4
	BlueKote form 7	LR17	LR27	LR37	LR47	LR57	LR67	LR77	LR87	LR97	LR107
	BlueKote form 8*	LR18	LR28	LR38	LR448	LR58	LR68	LR78	LR888	-	-
	Series 35	LR50M	LR75M	LR100M	LR125M	LR150M	LR200M	LR250M	LR300M	LR350M-TB	LR400M
	Sand cast aluminum form 7	LR17SA	LR27SA	LR37SA	LR47SA	LR57SA	LR67SA	-	-	-	-
	Sand cast aluminum form 9	LR19SA	LR29SA	LR39SA	LR49SA	LR59SA	LR69SA	LR789SA	LR889SA	LR989SA	LR1089SA
	BlueKote® form 7	L17-TB	L27-TB	L37-TB	L47-TB	L57-TB	L67-TB	-	-	-	-
	BlueKote form 7	TB17-TB	TB27	TB37	TB47	TB57	TB67	-	-	-	-
	BlueKote form 8*	TB18	TB28	TB38	TB448	TB58	TB68	-	-	-	-
	Series 35	TB50M	TB75M	TB100M	TB125M	TB150M	TB200M	-	-	-	-
	Sand cast aluminum form 7	TB17SA	TB27SA	TB37SA	TB47SA	TB57SA	TB67SA	-	-	-	-
	Sand cast aluminum form 9	TB19SA	TB29SA	TB39SA	TB49SA	TB59SA	TB69SA	-	-	-	-
	Stainless steel form 8**	TB18SST	TB28SST	TB38SST	TB48SST	TB58SST	TB68SST	-	-	-	-
	BlueKote form 7	X17	X27	X37	X47	X57	X67	-	-	-	-
	BlueKote form 8*	X18	X28	X38	X448	X58	X68	-	-	-	-
	Series 35	X50M	X75M	X100M	X125M	X150M	X200M	-	-	-	-
	Sand cast aluminum form 7	X17SA	X27SA	X37SA	X47SA	X57SA	X67SA	-	-	-	-
	Sand cast aluminum form 9	X19SA	X29SA	X39SA	-	-	-	-	-	-	-
	BlueKote form 7	E17	E27	E37	-	-	-	-	-	-	-
	BlueKote form 7	TA17	TA27	TA37	TA47	TA57	TA67	-	-	-	-

* ½" through 1¼" have (2) mounting holes; 1½" through 4" have (4) mounting holes
 ** With covers, gaskets and screws

Conduit bodies and covers

Covers and gaskets

Replacement covers and gaskets

		Hub size (in.)									
	Shape	½	¾	1	1¼	1½	2	2½	3	3½	4
	Stamped Form 7 steel*	170S	270S	370S	470S	570S	670S	870S	870S	970S	970S
	Form 8 steel*	180	280	380	480	580	680STB	880	880	980	980
	Form 7 aluminum*	170SA	270SA	370SA	470SA	570SA	670SA	870SA	870SA	970SA	970SA
	Form 9 aluminum	190SA**	290SA**	390SA**	490SA**	590SA**	690SA**	889SA	889SA	989SA	989SA
	Series 35	K50S	K75S	K100S	K125S	K125S	K200S	K250S	K250S	K350S	K350S
	Form 8 stainless Steel	180SST	280SST	380SST	480SST	580SST	680SST	-	-	-	-

* Form 7 and Form 8 covers include gasket.

** For Form 9 aluminum cover including gasket, replace suffix SA with GSA (Example : 190GSA)

		Hub size (in.)									
	Shape	½	¾	1	1¼	1½	2	2½	3	3½	4
	Sand cast Form 7 iron*	170F	270F	370F	470F	570F	670F	870F	870F	970F	970F
	Form 8 iron*	180F	280F	380F	480F	580F	680F	880F	880F	980F	980F
	Form 7 aluminum*	170FSA	270FSA	370FSA	470FSA	570FSA	670FSA	870FSA	870FSA	970FSA	970FSA
	Series 35	K50M	K75M	K100M	K125M	K125M	K200M	K250M	K250M	K350M	K350M

* Form 7 and Form 8 covers include gasket.

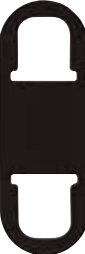
		Hub size (in.)									
	Shape	½	¾	1	1¼	1½	2	2½	3	3½	4
	Gasket Form 7*	GASK571	GASK572	GASK573	GASK574	GASK575	GASK576	GASK578	GASK578	GASK579	GASK579
	Form 8*	GASK581N	GASK582N	GASK583N	GASK584N	GASK585N	GASK586N	GASK588N	GASK588N	GASK589N	GASK589N
	Form 9*	GASK1941	GASK1942	GASK1943	GASK1944	GASK1945	GASK1946	GASK808N	GASK808N	GASK809N	GASK809N
	Series 35	GK50N	GK75N	GK100N	GK125-150N	GK125-150N	GK200N	GK250-300N	GK250-300N	GK350-400N	GK350-400N

* For ordering purposes, please use GASK in the catalog number (Example: GASK 571).

Conduit bodies and covers

Type 316 stainless steel form 8

Each conduit outlet body ships complete with gasket, cover and screws.



LU Form 8 conduit bodies with covers



Cat. no.	Hub size (in.)	Dimensions (in.)							Cu. in.
		A	B	C	D	E	F		
LU18SST	1/2	6.210	1.450	3.825	1.125	4.320	3.700	5.5	
LU28SST	3/4	6.981	1.645	4.245	1.500	4.921	4.300	8.5	
LU38SST	1	8.261	1.850	5.050	1.700	5.625	5.000	14.5	
LU48SST	1 1/4	9.923	2.200	5.975	2.200	6.730	5.810	26.5	
LU58SST	1 1/2	11.549	2.813	7.000	2.450	7.938	7.125	45.0	
LU68SST	2	13.989	3.820	8.500	2.900	9.797	9.125	116.5	

Diagrams

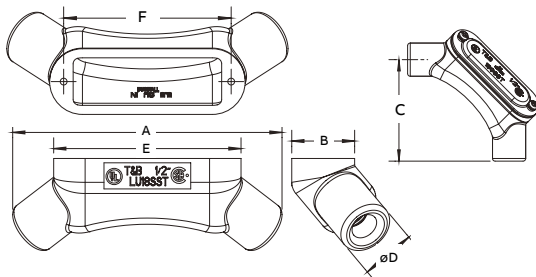

T Form 8 conduit bodies with covers



Cat. no.	Hub size (in.)	Dimensions (in.)							Cu. in.
		A	B	C	D	E	F		
T18SST	1/2	5.820	1.450	2.200	1.150	4.320	3.700	5.5	
T28SST	3/4	6.420	1.645	2.395	1.400	4.921	4.300	9.0	
T38SST	1	7.500	1.850	2.850	1.750	5.625	5.000	13.5	
T48SST	1 1/4	8.738	2.200	2.950	2.200	6.730	5.810	24.0	
T58SST	1 1/2	10.046	2.813	3.867	2.450	7.938	7.125	45.0	
T68SST	2	12.204	3.820	5.070	2.900	9.797	9.125	88.0	
T78SST	2.5	15.659	4.575	6.561	4.250	10.875	-	220	
T888SST	3	15.817	4.575	6.640	4.250	10.875	-	220	
T108SST	4	18.473	5.535	8.037	5.513	13.462	-	420	

Diagrams

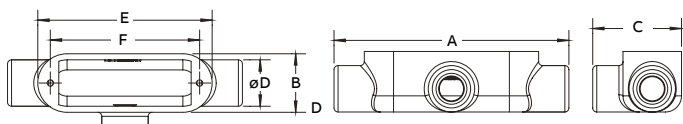

LB Form 8 conduit bodies with covers



Cat. no.	Hub size (in.)	Dimensions (in.)							Cu. in.
		A	B	C	D	E	F		
LB18SST	1/2	5.070	1.450	2.250	1.150	4.320	3.700	5.8	
LB28SST	3/4	5.671	1.645	2.530	1.400	4.921	4.300	8.0	
LB38SST	1	6.563	1.850	2.913	1.750	5.625	5.000	13.0	
LB48SST	1 1/4	7.734	2.200	3.315	2.200	6.730	5.810	23.0	
LB58SST	1 1/2	8.992	2.813	3.800	2.450	7.938	7.125	44.0	
LB68SST	2	11.000	3.820	4.810	2.900	9.797	9.125	88.0	
LB78SST	2 1/2	14.098	6.136	5.000	4.250	10.875	-	220	
LB888SST	3	14.177	6.215	5.000	4.250	10.875	-	220	
LB108SST	4	16.749	7.259	6.313	5.513	13.462	-	420	

Diagrams

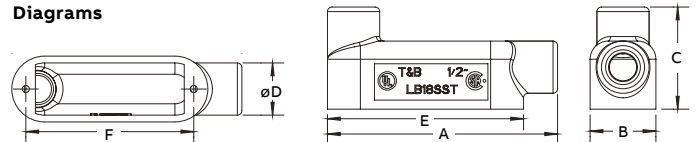

TB Form 8 conduit bodies with covers



Cat. no.	Hub size (in.)	Dimensions (in.)							Cu. in.
		A	B	C	D	E	F		
TB18SST	1/2	5.820	1.450	2.250	1.150	4.320	3.700	5.5	
TB28SST	3/4	6.420	1.645	2.530	1.400	4.921	4.300	9.0	
TB38SST	1	7.500	1.850	2.975	1.750	5.625	5.000	13.5	
TB48SST	1 1/4	8.484	2.200	3.319	2.200	6.730	5.810	24.0	
TB58SST	1 1/2	10.046	2.813	3.854	2.450	7.938	7.125	45.0	
TB68SST	2	12.129	3.820	4.810	2.900	9.797	9.125	88.0	

Diagrams

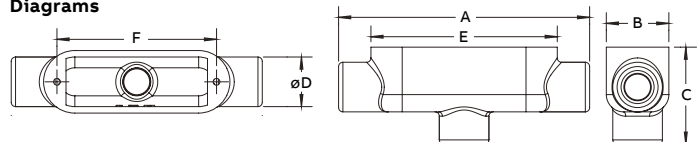

Conduit bodies and covers

Pre-assembled form 7 BlueKote®

Pre-assembled form 7 BlueKote conduit bodies

Form 7 body, gasket and cover – one number. Now you can order a conduit body, gasket and cover, pre-assembled, using one catalog number. ABB's pre-assembled cast conduit bodies help reduce transactions, eliminate the need for additional stocking bins and provide an easy inventory reduction. You'll also have less hassle with managing small parts in the truck or crib. Best of all, you can be absolutely confident that the right parts are in your hands when you need them.

T&B® Fittings conduit bodies and covers feature:

- BlueKote internal finish for faster, easier wire pulling
- Epoxy external finish for superior corrosion resistance
- Tapered NPT threads and integral bushings to protect wire insulation
- Bodies are designed with a flat back for more cubic inch capacity; the flat back also keeps the body more stable during installation, requiring fewer conduit straps
- T&B Fittings form 7 bodies and covers are interchangeable with Crouse-Hinds and Appleton's form 7 bodies and covers

Specifications

- Bodies: Class 30 gray iron alloy
- Covers: Stamped steel with stainless steel screws
- Gaskets: Neoprene
- Finish: Conduit bodies: zinc-plating with acrylic epoxy coating and internal
- PTFE-based BlueKote coating
- Covers: Stamped steel zinc-plating with a clear chromate coating
- Compliances: UL Standard: 514A, 514B Fed. Spec: W-C-586D
- CSA Standard: C22.2 No. 18

Crouse-Hinds is a trademark of Cooper Industries, Inc. Appleton is a trademark of the EGS Electrical Group, a joint venture of Emerson and SPX Corp.

Note: BlueKote is registered for conduit bodies but is not registered for a finish or a coating.

T&B Fittings pre-assembled conduit bodies, gaskets and covers



Cat. no.	Trade size (in.)	Pre-assembled products
C17CG-TB	1/2	C17 body, cover and gasket
C27CG-TB	3/4	C27 body, cover and gasket
C37CG-TB	1	C37 body, cover and gasket
C47CG-TB	1 1/4	C47 body, cover and gasket
C57CG-TB	1 1/2	C57 body, cover and gasket
C67CG-TB	2	C67 body, cover and gasket
LB17CG-TB	1/2	LB17 body, cover and gasket
LB27CG-TB	3/4	LB27 body, cover and gasket
LB37CG-TB	1	LB37 body, cover and gasket
LB47CG-TB	1 1/4	LB47 body, cover and gasket
LB57CG-TB	1 1/2	LB57 body, cover and gasket
LB67CG-TB	2	LB67 body, cover and gasket
LL17CG-TB	1/2	LL17 body, cover and gasket
LL27CG-TB	3/4	LL27 body, cover and gasket
LL37CG-TB	1	LL37 body, cover and gasket
LL47CG-TB	1 1/4	LL47 body, cover and gasket
LL57CG-TB	1 1/2	LL57 body, cover and gasket
LL67CG-TB	2	LL67 body, cover and gasket
LR17CG-TB	1/2	LR17 body, cover and gasket
LR27CG-TB	3/4	LR27 body, cover and gasket
LR37CG-TB	1	LR37 body, cover and gasket
LR47CG-TB	1 1/4	LR47 body, cover and gasket
LR57CG-TB	1 1/2	LR57 body, cover and gasket
LR67CG-TB	2	LR67 body, cover and gasket
T17CG-TB	1/2	T17 body, cover and gasket
T27CG-TB	3/4	T27 body, cover and gasket
T37CG-TB	1	T37 body, cover and gasket
T47CG-TB	1 1/4	T47 body, cover and gasket
T57CG-TB	1 1/2	T57 body, cover and gasket
T67CG-TB	2	T67 body, cover and gasket
TB17CG-TB	1/2	TB17 body, cover and gasket
TB27CG-TB	3/4	TB27 body, cover and gasket
TB37CG-TB	1	TB37 body, cover and gasket
TB47CG-TB	1 1/4	TB47 body, cover and gasket
TB57CG-TB	1 1/2	TB57 body, cover and gasket
TB67CG-TB	2	TB67 body, cover and gasket
X17CG-TB	1/2	X17 body, cover and gasket
X27CG-TB	3/4	X27 body, cover and gasket
X37CG-TB	1	X37 body, cover and gasket
X47CG-TB	1 1/4	X47 body, cover and gasket
X57CG-TB	1 1/2	X57 body, cover and gasket
X67CG-TB	2	X67 body, cover and gasket

For aluminum conduit bodies pre-assembled with covers and gaskets, request Red•Dot® D-PAK® series conduit bodies for rigid and IMC conduit.



Conduit bodies and covers

Sand cast aluminum form 7



LB Sand cast aluminum form 7 conduit bodies



Cat. no.	Hub size (in.)	Dimensions (in.)						Cu. in.
		A	B	C	D	E		
LB17SA	1/2	4.63	2.19	1.41	1.03	3.19	4.2	
LB27SA	3/4	5.25	2.47	1.59	1.22	3.81	6.8	
LB37SA	1	6.22	2.88	1.75	1.38	4.56	11.0	
LB47SA	1 1/4	6.59	3.34	2.19	1.81	5.03	19.5	
LB57SA	1 1/2	6.97	3.59	2.44	2.06	5.44	25.6	
LB67SA	2	8.13	4.25	3.06	2.44	6.41	51.2	
LB77SA	2 1/2	10.56	5.19	4.25	3.63	8.38	100.4	
LB87SA	3	10.66	6.03	4.25	3.63	8.38	126.2	
LB97SA	3 1/2	11.06	6.69	5.25	4.44	10.25	219.0	
LB107SA	4	12.81	7.72	5.25	4.44	10.25	247.1	

Diagrams

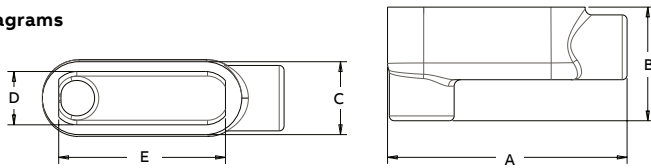

LR Sand cast aluminum form 7 conduit bodies



Cat. no.	Hub size (in.)	Dimensions (in.)						Cu. in.
		A	B	C	D	E		
LR17SA	1/2	4.38	1.41	2.25	1.03	3.19	4.5	
LR27SA	3/4	5.31	1.63	2.44	1.19	3.81	7.5	
LR37SA	1	6.22	1.88	2.78	1.38	4.56	11.2	
LR47SA	1 1/4	6.63	2.31	3.22	1.81	5.03	20.3	
LR57SA	1 1/2	6.97	2.56	3.47	2.06	5.44	27.8	
LR67SA	2	8.13	3.19	4.13	2.44	6.25	54.0	

Diagrams

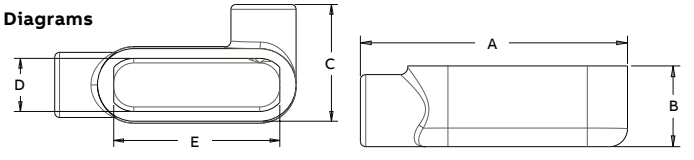

LL Sand cast aluminum form 7 conduit bodies



Cat. no.	Hub size (in.)	Dimensions (in.)						Cu. in.
		A	B	C	D	E		
LL17SA	1/2	4.38	1.41	2.25	1.03	3.19	4.5	
LL27SA	3/4	5.31	1.63	2.44	1.19	3.81	7.2	
LL37SA	1	6.22	1.88	2.78	1.38	4.56	11.5	
LL47SA	1 1/4	6.63	2.31	3.22	1.81	5.03	20.0	
LL57SA	1 1/2	6.97	2.56	3.47	2.06	5.44	28.0	
LL67SA	2	8.13	3.19	4.13	2.44	6.25	54.2	

Diagrams

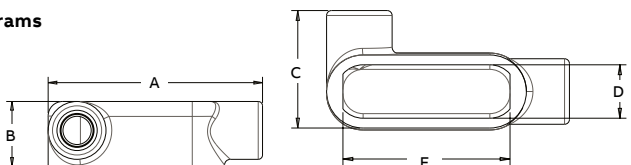

C Sand cast aluminum form 7 conduit bodies



Cat. no.	Hub size (in.)	Dimensions (in.)						Cu. in.
		A	B	C	D	E		
C17SA	1/2	5.44	1.41	1.41	1.00	3.19	4.8	
C27SA	3/4	6.16	1.63	1.59	1.22	3.81	7.5	
C37SA	1	7.22	1.88	1.75	1.38	4.56	11.8	
C47SA	1 1/4	7.63	2.31	2.19	1.91	5.03	19.8	
C57SA	1 1/2	8.00	2.56	2.44	2.06	5.44	27.8	
C67SA	2	9.16	3.22	3.06	2.44	6.25	53.2	

Diagrams

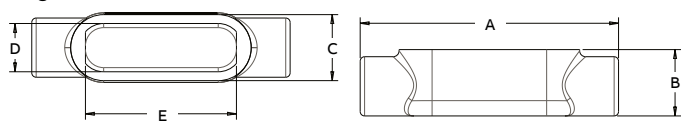

Conduit bodies and covers

Sand cast aluminum form 7



LU® Sand cast aluminum form 7 conduit bodies



Cat. no.	Hub size (in.)	Dimensions (in.)						Cu. in.
		A	B	C	D	E	F	
LU17SA	1/2	5.53	1.50	2.88	1.03	3.19	3.31	5.1
LU27SA	3/4	6.28	1.72	3.22	1.22	3.81	3.75	8.7
LU37SA	1	7.34	1.97	3.78	1.38	4.56	4.41	13.4
LU47SA	1 1/4	8.38	2.47	4.34	1.81	5.03	4.91	23.8
LU57SA	1 1/2	8.97	2.72	4.53	2.06	5.44	5.19	29.6
LU67SA	2	10.78	3.44	5.41	2.44	6.25	6.25	59.4

Diagrams

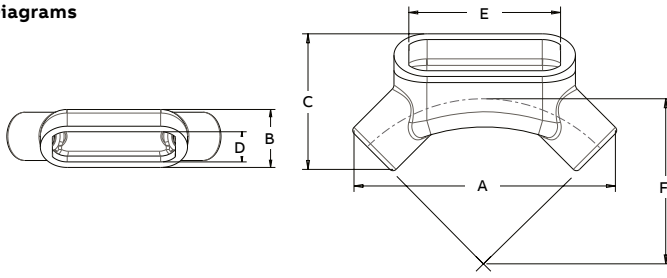

T Sand cast aluminum form 7 conduit bodies



Cat. no.	Hub size (in.)	Dimensions (in.)					Cu. in.
		A	B	C	D	E	
T17SA	1/2	5.44	1.78	2.28	1.03	3.19	5.5
T27SA	3/4	6.16	2.00	2.59	1.22	3.81	9.1
T37SA	1	7.22	2.28	3.22	1.38	4.56	15.5
T47SA	1 1/4	7.63	2.31	3.22	1.81	5.03	20.1
T57SA	1 1/2	8.00	2.56	3.47	2.06	5.44	27.1
T67SA	2	9.16	3.19	4.09	2.44	6.41	51.0
T77SA	2 1/2	12.13	3.63	5.81	3.63	8.38	104.6
T87SA	3	12.28	4.41	5.91	3.63	8.38	135.2
T97SA	3 1/2	14.44	4.91	6.94	4.44	10.25	230.0
T107SA	4	14.50	5.41	6.97	4.44	10.25	260.3

Diagrams

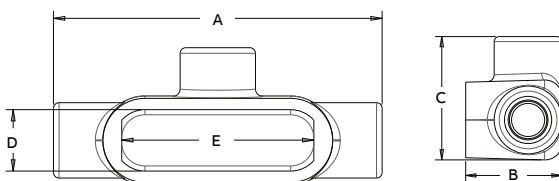

TB Sand cast aluminum form 7 conduit bodies



Cat. no.	Hub size (in.)	Dimensions (in.)					Cu. in.
		A	B	C	D	E	
TB17SA	1/2	5.44	2.59	1.50	1.03	3.19	5.6
TB27SA	3/4	6.16	2.84	1.66	1.19	3.81	9.0
TB37SA	1	7.22	3.28	1.78	1.38	4.56	13.1
TB47SA	1 1/4	7.63	3.34	2.19	1.81	5.03	19.3
TB57SA	1 1/2	8.00	3.59	2.44	2.06	5.44	25.0
TB67SA	2	9.16	4.25	3.06	2.44	6.41	51.6

Diagrams

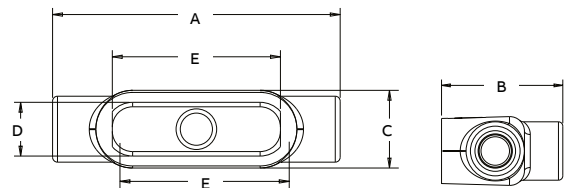

X Sand cast aluminum form 7 conduit bodies



Cat. no.	Hub size (in.)	Dimensions (in.)					Cu. in.
		A	B	C	D	E	
X17SA	1/2	5.44	3.06	1.78	1.03	3.19	5.8
X27SA	3/4	6.16	3.44	2.00	1.22	3.81	10.3
X37SA	1	7.22	4.22	2.28	1.38	4.56	16.4
X47SA	1 1/4	7.63	4.25	2.31	1.81	5.03	21.3
X57SA	1 1/2	8.00	4.50	2.56	2.06	5.44	28.6
X67SA	2	9.16	5.16	3.19	2.44	6.41	53.5

Diagrams

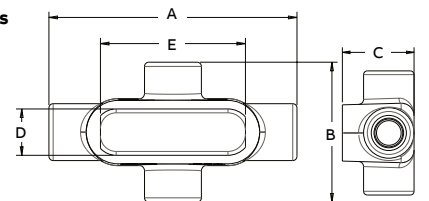

Conduit bodies and covers

Sand cast aluminum form 9



C Sand cast aluminum form 9 conduit bodies



Cat. no.	Hub size (in.)	Dimensions (in.)						Cu. in.
		A	B	C	D	E		
C19SA	½"	5.858	1.5	1.392	1.018	3.307	4.5	
C29SA	¾"	6.48	1.78	1.56	1.186	3.898	7.5	
C39SA	1"	7.578	1.975	1.756	1.382	4.559	11.5	
C49SA	1¼"	8.593	2.315	2.2	1.826	5.197	22.3	
C59SA	1½"	9.238	2.8	2.5	1.788	5.892	34	
C69SA	2"	11.578	3.56	3.189	2.349	8.11	80.0	
C789SA	2½"	15.522	4.575	5.04	4.29	10.827	212	
C889SA	3"	15.68	4.575	5.04	4.29	10.827	216	
C989SA	3½"	18.452	5.535	6.338	5.538	13.438	408	
C1089SA	4"	18.498	5.535	6.339	5.538	13.438	440	

Diagrams

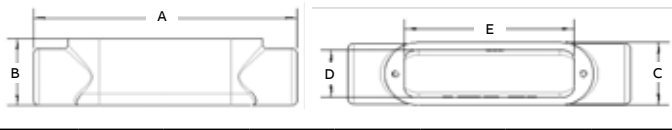

LB Sand cast aluminum form 9 conduit bodies



Cat. no.	Hub size (in.)	Dimensions (in.)						Cu. in.
		A	B	C	D	E		
LB19SA	½"	5.034	2.231	1.392	1.018	3.307	4.5	
LB29SA	¾"	5.64	2.62	1.56	1.186	3.898	7.5	
LB39SA	1"	6.569	2.984	1.756	1.382	4.55	11.5	
LB49SA	1¼"	7.767	3.344	2.2	1.826	5.197	22.3	
LB59SA	1½"	8.209	3.829	2.5	2.1	5.906	34	
LB69SA	2"	10.533	4.605	3.228	2.388	7.941	80.0	
LB789SA	2½"	13.961	6.011	5.04	4.29	10.827	212	
LB889SA	3"	14.04	6.215	5.04	4.29	10.827	216	
LB989SA	3½"	16.751	7.236	6.339	5.576	13.437	408	
LB1089SA	4"	16.774	7.259	6.339	5.573	13.438	440	

Diagrams

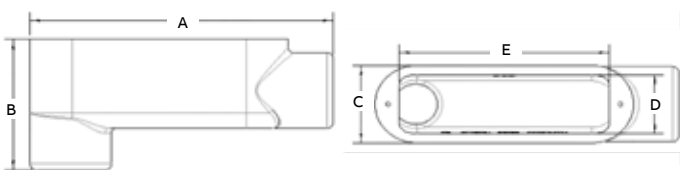

LL Sand cast aluminum form 9 conduit bodies



Cat. no.	Hub size (in.)	Dimensions (in.)						Cu. in.
		A	B	C	D	E		
LL19SA	½"	5.034	1.5	2.213	1.018	3.28	4.5	
LL29SA	¾"	5.64	1.78	2.4	1.186	3.898	7.5	
LL39SA	1"	6.569	1.975	2.765	1.382	4.55	11.5	
LL49SA	1¼"	7.564	2.315	3.229	1.826	5.197	22.3	
LL59SA	1½"	8.591	2.8	3.529	2.126	5.906	34	
LL69SA	2"	10.714	3.56	4.234	2.349	8.11	80.0	
LL789SA	2½"	13.961	4.575	6.601	4.29	10.827	212	
LL889SA	3"	14.04	4.575	6.68	4.29	10.827	216	
LL989SA	3½"	16.563	5.535	8.04	5.577	13.437	408	
LL1089SA	4"	16.774	5.535	8.063	5.577	13.438	440	

Diagrams

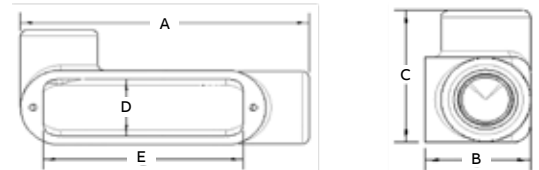

LR Sand cast aluminum form 9 conduit bodies



Cat. no.	Hub size (in.)	Dimensions (in.)						Cu. in.
		A	B	C	D	E		
LR19SA	½"	5.034	1.5	2.213	1.018	3.28	4.5	
LR29SA	¾"	5.64	1.78	2.4	1.186	3.898	7.5	
LR39SA	1"	6.569	1.975	2.765	1.382	4.55	11.5	
LR49SA	1¼"	7.564	2.315	3.229	1.826	5.197	22.3	
LR59SA	1½"	8.591	2.8	3.529	2.126	5.906	34	
LR69SA	2"	10.714	3.56	4.234	2.349	8.11	80.0	
LR789SA	2½"	13.961	4.575	6.601	4.29	10.827	212	
LR889SA	3"	14.04	4.575	6.68	4.29	10.827	216	
LR989SA	3½"	16.563	5.535	8.04	5.577	13.437	408	
LR1089SA	4"	16.774	5.535	8.063	5.577	13.438	440	

Diagrams

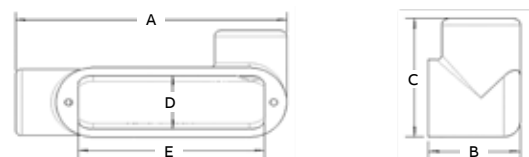

Conduit bodies and covers

Form 9 sand cast aluminum



LU Sand cast aluminum form 9 conduit bodies



Cat. no.	Hub size (in.)	Dimensions (in.)						Cu. in.
		A	B	C	D	E	Radius	
LU19SA	½	6.21	2.701	1.5	1.018	3.28	4.415	5.3
LU29SA	¾	6.97	3.047	1.698	1.186	3.898	4.92	8.0
LU39SA	1	8.276	3.651	2.02	1.445	4.559	6.143	14.0
LU49SA	1¼	9.902	4.266	2.362	1.826	5.29	7.666	30.8
LU59SA	1½	10.256	5.127	2.609	2.126	5.906	8.214	41.0
LU69SA	2	13.968	6.153	3.421	2.815	7.941	8.5	97.0

Diagrams

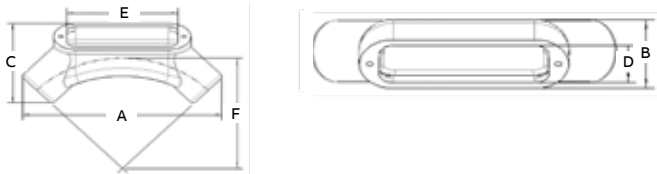

T Sand cast aluminum form 9 conduit bodies



Cat. no.	Hub size (in.)	Dimensions (in.)						Cu. in.
		A	B	C	D	E		
T19SA	½	5.958	1.775	2.393	1.078	3.307	6.3	
T29SA	¾	6.455	2	2.591	1.185	3.925	9.3	
T39SA	1	7.578	2.275	2.765	1.382	4.559	14.0	
T49SA	1¼	8.593	2.315	3.229	1.826	5.197	22.0	
T59SA	1½	9.243	2.8	3.529	2.126	5.906	34.8	
T69SA	2	11.578	3.56	4.234	2.815	8.11	80.5	
T789SA	2½	15.522	4.575	6.601	4.25	10.827	175	
T889SA	3	15.68	4.575	6.68	4.25	10.827	236	
T989SA	3½	18.452	5.535	8.04	5.539	13.437	435	
T1089SA	4	18.498	5.535	8.063	5.539	13.438	450	

Diagrams

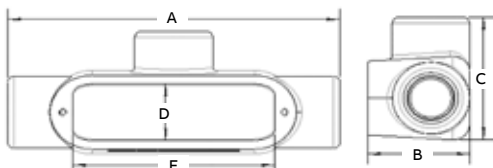

TB Sand cast aluminum form 9 conduit bodies



Cat. no.	Hub size (in.)	Dimensions (in.)						Cu. in.
		A	B	C	D	E		
TB19SA	½	5.958	2.596	1.556	1.018	3.307	6.3	
TB29SA	¾	6.6	2.84	1.715	1.186	3.898	9.3	
TB39SA	1	7.644	3.284	1.756	1.382	4.559	14.0	
TB49SA	1¼	8.788	3.344	2.2	1.826	5.197	22.0	
TB59SA	1½	9.996	3.604	2.5	1.784	5.883	34.8	
TB69SA	2	11.578	4.605	3.189	2.815	8.11	80.5	

Diagrams

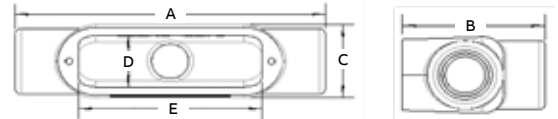

X Sand cast aluminum form 9 conduit bodies



Cat. no.	Hub size (in.)	Dimensions (in.)						Cu. in.
		A	B	C	D	E		
X19SA	½	5.958	1.775	3.094	1.018	3.28	6.3	
X29SA	¾	6.61	2	3.37	1.186	3.898	9.3	
X39SA	1	7.578	2.275	3.774	1.382	4.559	14.0	

Diagrams

