

# Compression connectors for copper conductor

One-hole lugs – Standard barrel 600 V to 35 kV



**Material** – High-conductivity wrought copper

**Finish** – Electro tin plate



One-hole lugs – Standard barrel 600 V to 35 kV

Diagrams	Cat. no.	Code (AWG or kcmil)	Wire size Flex class G, H, I, K, M†	Bolt size (in.)	Dimensions (in)						Die code	Die color
					A	B	C	D	E	F		
	54101	#14-10	–	¼	1.23	0.56	0.50	0.05	0.20	¼	ERG4002	"C" nest
	256-30695-1351			#8	1.36	0.68	0.36	0.05	0.20	¼	ERG4005	
	256-30695-1352			¼	1.36	0.68	0.41	0.05	0.20	¼		
	256-30695-263			¼	1.69	0.81	0.50	0.07	0.20	¼		
	54104	#8	23 Navy	#10	1.16	0.50	0.39	0.08	0.25	7/32	21	Red
	54130		#8 Weld	¼	1.20	0.61	0.45	0.07	0.25	¼	21	
	54131		37/24 = 14.9 kcmil	5/16	1.33	0.64	0.56	0.05	0.25	9/32	21	
	54132			3/8	1.33	0.64	0.56	0.05	0.25	9/32	21	
	256-30695-424			½	1.75	1.31	1.00	0.13	0.25	½	21	
	256-30695-1361	#6	#30 Navy	#12	1.23	0.53	0.44	0.07	0.31	7/32	24	Blue
	54134		#6 Weld	#10	1.23	0.53	0.44	0.07	0.31	7/32	24	
	54105		61/24 = 24.6 kcmil	¼	1.23	0.53	0.44	0.07	0.31	7/32	24	
	54135		133/0.014	5/16	1.41	0.67	0.60	0.07	0.31	5/16	24	
	54136			3/8	1.41	0.67	0.60	0.07	0.31	5/16	24	
	256-30695-282			3/8	1.41	0.75	0.56	0.06	0.31	5/16	24	
	256-30695-422			½	1.75	1.31	1.00	0.13	0.31	½	24	
256-30695-1362	#4	#4 Weld	#12	1.38	0.60	0.55	0.09	0.37	¼	29	Gray	
54138		40–50 Navy	#10	1.38	0.60	0.55	0.09	0.37	¼	29		
54106		91/24 = 36.7 kcmil	¼	1.38	0.60	0.55	0.09	0.37	¼	29		
54139		133/0.0177	5/16	1.42	0.66	0.61	0.07	0.37	5/16	29		
54140		49/0.029	3/8	1.42	0.66	0.61	0.07	0.37	5/16	29		
256-30695-233		#5 91/24	3/8	1.56	0.75	0.59	0.06	0.37	5/16	29		
256-30695-264			½	2.20	1.40	1.00	0.06	0.37	½	29		
	54107	#2	#60 Navy	¼	1.50	0.65	0.59	0.11	0.41	¼	33	Brown
	54142-TB		125/24 = 50.5 kcmil	5/16	1.73	0.88	0.59	0.11	0.41	3/8	33	
	54143-TB		#3 Weld	3/8	1.65	0.80	0.59	0.11	0.41	3/8	33	
	54145-TB			½	1.92	1.08	0.75	0.08	0.41	½	33	
	54108	#1	75 Navy, #2 Weld	¼	1.50	0.65	0.68	0.11	0.47	¼	37	Green
	54147		150/24 = 60.5 kcmil	5/16	1.73	0.93	0.68	0.11	0.47	3/8	37	
	54148		175/24 = 70.6 kcmil	3/8	1.78	0.98	0.68	0.11	0.47	3/8	37	
	54150		133/0.0223	½	2.10	1.25	0.76	0.11	0.47	½	37	
	54152-TB		#100 Navy	¼	1.60	0.65	0.75	0.13	0.52	¼	42	
54153-TB		#1 Weld	5/16	1.83	0.88	0.75	0.13	0.52	3/8	42	Pink	
54109		225/24 = 90.8 kcmil	3/8	1.88	0.93	0.75	0.13	0.52	3/8	42		
54155-TB		133/0.0254	½	2.20	1.25	0.75	0.13	0.52	½	42		
256-30695-1383			5/8	2.54	1.50	0.88	0.13	0.52	5/8	42		

† Contact technical services for specific stranding listings.  
Tooling – see pages 104-127. Die selector chart – see pages 128-133.

# Compression connectors for copper conductor

One-hole lugs – Standard barrel 600 V to 35 kV (continued)



**Material** – High-conductivity wrought copper

**Finish** – Electro tin plate



One-hole lugs – Standard barrel 600 V to 35 kV

Diagrams	Cat. no.	Code (AWG or kcmil)	Wire size Flex class G, H, I, K, M <sup>†</sup>	Bolt size (in.)	Dimensions (in)						Die code	Die color	
					A	B	C	D	E	F			
	54157	2/0	125 Navy	1/4	1.65	0.65	0.83	0.13	0.57	1/4	45	Black	
	54158		1/0 Weld	5/16	1.88	0.88	0.83	0.13	0.57	3/8	45		
	54110		275/24 = 111 kcmil	3/8	1.93	0.93	0.83	0.13	0.57	3/8	45		
	54160		427/0.0155	1/2	2.25	1.25	0.83	0.13	0.57	1/2	45		
	256-30695-131		133/0.0282	5/8	2.56	1.50	0.83	0.13	0.57	5/8	45		
		54162-TB	3/0	150 Navy, 2/0 Weld	1/4	1.75	0.65	0.92	0.13	0.63	1/4	50	Orange
		54163-TB		325/24 = 131 kcmil	5/16	1.98	0.88	0.92	0.13	0.63	3/8	50	
		54111		133/0.0316, 259/0.0227	3/8	2.03	0.93	0.92	0.13	0.63	3/8	50	
		54165-TB		427/0.0177	1/2	2.35	1.25	0.92	0.13	0.63	1/2	50	
			54167	4/0	200 Navy	1/4	1.90	0.65	1.03	0.14	0.70	1/4	54
54168			3/0 Weld	5/16	2.13	0.87	1.03	0.14	0.70	3/8	54		
54112			450/24 = 182 kcmil	3/8	2.18	0.93	1.03	0.14	0.70	3/8	54		
54170			703/0.0154	1/2	2.50	1.25	1.03	0.14	0.70	1/2	54	Yellow	
256-30695-1174				3/4	2.86	1.56	1.03	0.14	0.70	3/4	54		
58161	-		4/0 Weld	1/4	2.23	0.78	1.25	0.15	0.79	3/8	62		
	58162		550/24 = 222 kcmil	5/16	2.33	0.88	1.25	0.15	0.79	3/8	62	White	
	58163		133/0.0399	3/8	2.38	0.93	1.25	0.15	0.79	3/8	62		
	58165		259/0.0286	1/2	2.76	1.25	1.25	0.15	0.79	1/2	62		
	58166		637/0.0183	5/8	3.03	1.58	1.25	0.15	0.79	5/8	62		
	54172-TB	250	250 Navy	1/4	2.00	0.65	1.13	0.14	0.77	1/2	62		
	54173			5/16	2.23	0.88	1.13	0.14	0.77	3/8	62		
	54174			3/8	2.28	0.93	1.13	0.14	0.77	3/8	62		
	54113			1/2	2.60	1.25	1.13	0.14	0.77	1/2	62		
	58168	-	250 Weld, 50/24 = 262 kcmil, 259/0.0311, 703/0.0189	1/2	2.70	1.25	1.25	0.15	0.85	1/2	66		
	54178	300	300 Navy	5/16	2.33	0.88	1.25	0.15	0.85	3/8	66		
54179			3/8	2.43	0.93	1.25	0.15	0.85	3/8	66			
54114			1/2	2.70	1.25	1.25	0.15	0.85	1/2	66			
54181			5/8	3.03	1.58	1.25	0.15	0.85	3/8	66			
58171	-	300 Weld, 259/034, 427/0.0265, 889/0.0183 775/24 = 313 kcmil	1/2	2.85	1.25	1.36	0.18	0.93	1/2	71	Red		
256-30695-112	350	350 Navy	3/8	2.90	1.13	1.36	0.18	0.93	1/2	71			
54115			1/2	2.85	1.25	1.36	0.18	0.93	1/2	71			
54183			5/8	3.21	1.58	1.36	0.18	0.93	3/4	71			

<sup>†</sup> Contact technical services for specific stranding listings.

Tooling – see pages 104-127. Die selector chart – see pages 128-133.

## Compression connectors for copper conductor

One-hole lugs – Standard barrel 600 V to 35 kV (continued)



**Material** – High-conductivity wrought copper

**Finish** – Electro tin plate



One-hole lugs – Standard barrel 600 V to 35 kV

Diagrams	Cat. no.	Code (AWG or kcmil)	Wire size Flex class G, H, I, K, M†	Bolt size (in.)	Dimensions (in)						Die code	Die color
					A	B	C	D	E	F		
	58174	-	350 Weld, 259/0.0368, 427/0.0285, 703/0.0224, 889/0.0201	1/2	3.35	1.25	1.61	0.22	1.09	1/2	76	Blue
	54116	400	400 Navy	1/4	3.20	1.25	1.41	0.17	0.96	1/2	76	Blue
	54185	-	400 Navy	5/8	3.53	1.58	1.41	0.17	0.96	3/4	76	Blue
	256-30695-1403	-	400 Weld	3/8	3.31	1.31	1.61	0.22	1.04	5/8	80	-
	58177	-	925/24 = 373 kcmil 259/0.0393 or 427/0.0306	1/2	3.31	1.25	1.61	0.22	1.04	1/2	80	-
	256-30695-339	500	500 Navy	3/8	3.10	1.00	1.61	0.22	1.10	3/8	87	Brown
	54118	-	500 Navy	1/2	3.30	1.25	1.61	0.22	1.10	1/2	87	Brown
	54187	-	500 Navy	5/8	3.63	1.58	1.61	0.22	1.10	5/8	87	Brown
	58180	-	450 Flex, 1127, 4522 1100/24 = 444 kcmil	5/8	3.79	1.58	1.75	0.24	1.20	5/8	94	Green
	256-30695-1370	600	-	1/2	3.65	1.44	1.75	0.24	1.20	31/64	94	Green
	54120	-	600 Navy	5/8	3.79	1.58	1.75	0.24	1.20	5/8	94	Green
	54122-TB	700	-	5/8	3.68	1.58	1.84	0.23	1.26	5/8	99	Pink
	256-30695-1404	-	1325/24 = 535 kcmil	3/8	3.29	1.29	1.81	0.28	1.25	21/32	99	Pink
	256-30695-1405	-	500 Flex 427/0.0342	1/2	3.29	1.29	1.81	0.28	1.25	21/32	99	Pink
	256-30695-840	-	259, 4125, 5054	1/2	4.00	1.69	1.81	0.28	1.25	31/64	99	Pink
58182	-	600 Navy	5/8	3.83	1.58	1.81	0.28	1.25	5/8	99	Pink	
256-30695-193	750	600 Flex 427	1/2	4.00	1.69	1.94	0.27	1.33	31/64	106	Black	
54123-TB	-	750 Navy	5/8	3.87	1.58	1.94	0.27	1.33	5/8	106	Black	
58184	-	1600/24 = 646 kcmil	5/8	3.80	1.58	1.94	0.27	1.33	5/8	106	Black	
54124-TB	800	800 Navy	5/8	4.04	1.58	2.01	0.27	1.38	5/8	107	Orange	
256-30695-843	900	1925/24 = 777 kcmil	1/2	4.31	1.81	2.17	0.31	1.50	7/8	115	Yellow	
54126	-	900 Navy	5/8	4.15	1.58	2.17	0.31	1.50	5/8	115	Yellow	
54126	-	900 Navy	5/8	4.15	1.58	2.17	0.31	1.50	5/8	115	Yellow	
54128	1000	1000 Navy	5/8	4.09	1.58	2.27	0.30	1.55	5/8	125	-	

† Contact technical services for specific stranding listings.

Note: angled lugs can be readily available as: 15°, 30°, 45°, 60°, and 90°.

Tooling – see pages 104-127. Die selector chart – see pages 128-133.

# Compression connectors for copper conductor

## One-hole lugs – 45° Standard barrel 600 V to 35 kV



**Material** – High-conductivity wrought copper  
**Finish** – Electro tin plate



One-hole lugs – 45° Standard barrel 600 V to 35 kV

Cat. no.	Code (AWG or kcmil)	Wire size Flex class G, H, I, K, M†	Bolt size (in.)	Dimensions (in)					Die code	Die color	
				B	C	D	E	F			
<b>Diagrams</b>	54104UF	#8	23 Navy	#10	0.50	0.39	0.08	0.25	7/32	21	Red
	54130UF		#8 Weld	1/4	0.61	0.45	0.07	0.25	1/4	21	
	54131UF		37/24 = 14.9 kcmil	5/16	0.64	0.56	0.05	0.25	9/32	21	
	54132UF			3/8	0.64	0.56	0.05	0.25	9/32	21	
	54134UF	#6	30 Navy	#10	0.53	0.44	0.07	0.31	7/32	24	Blue
	54105UF		#6 Weld	1/4	0.53	0.44	0.07	0.31	7/32	24	
	54135UF		61/24 = 24.6 kcmil	5/16	0.67	0.60	0.07	0.31	5/16	24	
	54136UF		133/0.014	3/8	0.67	0.60	0.07	0.31	5/16	24	
	54138UF	#4	#4 Weld	#10	0.60	0.55	0.09	0.37	1/4	29	Gray
	54106UF		40–50 Navy	1/4	0.60	0.55	0.09	0.37	1/4	29	
	54139UF		91/24 = 36.7 kcmil	5/16	0.66	0.61	0.07	0.37	5/16	29	
	54140UF		133/0.0177	3/8	0.66	0.61	0.07	0.37	5/16	29	
	256-30695-264UF		49/0.029	3/8	0.66	0.61	0.07	0.37	5/16	29	
	54107UF	#2	#5–91/24	1/2	1.40	1.00	0.06	0.37	1/2	29	
	54107UF		60 Navy	1/4	0.65	0.59	0.11	0.41	1/4	33	Brown
	54142UF		125/24 = 50.4 kcmil	5/16	0.88	0.59	0.11	0.41	3/8	33	
	54143UF		#3 Weld	3/8	0.80	0.59	0.11	0.41	3/8	33	
	54145UF			1/2	1.08	0.75	0.08	0.41	1/2	33	
	54108UF	#1	75 Navy, #2 Weld	1/4	0.65	0.68	0.11	0.47	1/4	37	Green
	54147UF		150/24 = 60.5 kcmil	5/16	0.93	0.68	0.11	0.47	3/8	37	
	54148UF		175/24 = 70.6 kcmil	3/8	0.98	0.68	0.11	0.47	3/8	37	
	54150UF		133/0.0223	1/2	1.25	0.76	0.11	0.47	1/2	37	
	54152UF	1/0	100 Navy	1/4	0.65	0.75	0.13	0.52	1/4	42	Pink
	54153UF		#1 Weld	5/16	0.88	0.75	0.13	0.52	3/8	42	
	54109UF		225/24 = 90.8 kcmil	3/8	0.93	0.75	0.13	0.52	3/8	42	
	54155UF		133/0.0254	1/2	1.25	0.75	0.13	0.52	1/2	42	
	54157UF	2/0	125 Navy	1/4	0.65	0.83	0.13	0.57	1/4	45	Black
	54158UF		1/0 Weld	5/16	0.88	0.83	0.13	0.57	3/8	45	
	54110UF		275/24 = 111 kcmil	3/8	0.93	0.83	0.13	0.57	3/8	45	
	54160UF		427/0.0155, 133/0.0282	1/2	1.25	0.83	0.13	0.57	1/2	45	
	54162UF	3/0	150 Navy, 2/0 Weld	1/4	0.65	0.92	0.13	0.63	1/4	50	Orange
	54163UF		325/24 = 131 kcmil	5/16	0.88	0.92	0.13	0.63	3/8	50	
	54111UF		133/0.0316, 259/0.0227	3/8	0.93	0.92	0.13	0.63	3/8	50	
	54165UF		427/0.0177	1/2	1.25	0.92	0.13	0.63	1/2	50	
	54167UF	4/0	200 Navy	1/4	0.65	1.03	0.14	0.70	1/4	54	Purple
	54168UF		3/0 Weld	5/16	0.87	1.03	0.14	0.70	3/8	54	
	54112UF		450/24 = 182 kcmil	3/8	0.93	1.03	0.14	0.70	3/8	54	
	54170UF		703/0.0154	1/2	1.25	1.03	0.14	0.70	1/2	54	
	58161UF	–	4/0 Weld	1/4	0.78	1.25	0.15	0.79	3/8	62	Yellow
	58162UF		550/24 = 222 kcmil	5/16	0.88	1.25	0.15	0.79	3/8	62	
	58163UF		133/0.0399	3/8	0.93	1.25	0.15	0.79	3/8	62	
	58165UF		259/0.0286	1/2	1.25	1.25	0.15	0.79	1/2	62	
	58166UF		637/0.0183	5/8	1.58	1.25	0.15	0.79	5/8	62	
	58166UF			5/8	1.58	1.25	0.15	0.79	5/8	62	

† Contact technical services for specific stranding listings. Tooling – see pages 104-127. Die selector chart – see pages 128-133.

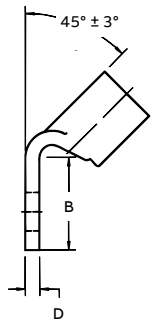
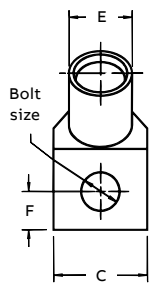

## Compression connectors for copper conductor

One-hole lugs – 45° Standard barrel 600 V to 35 kV (continued)



**Material** – High-conductivity wrought copper

**Finish** – Electro tin plate



One-hole lugs – 45° Standard barrel 600 V to 35 kV

Diagrams	Cat. no.	Code (AWG or kcmil)	Wire size		Bolt size (in.)	Dimensions (in)					Die code	Die color	
			Flex class G, H, I, K, M <sup>†</sup>			B	C	D	E	F			
	54172UF	250	250 Navy		1/4	0.65	1.13	0.14	0.77	1/4	62	Yellow	
	54173UF				5/16	0.88	1.13	0.14	0.77	3/8	62		
	54174UF				3/8	0.93	1.13	0.14	0.77	3/8	62		
	54113UF				1/2	1.25	1.13	0.14	0.77	1/2	62		
	58168UF	–		250 Weld, 650/24 = 262 kcmil, 259/0.0311, 703/0.0189		1/2	1.25	1.25	0.15	0.85	1/2	66	White
	54178UF	300	300 Navy		5/16	0.88	1.25	0.15	0.85	3/8	66		
	54179UF					3/8	0.93	1.25	0.15	0.85	3/8	66	
	54114UF					1/2	1.25	1.25	0.15	0.85	1/2	66	
	54181UF					5/8	1.58	1.25	0.15	0.85	5/8	66	
	58171UF	–		300 Weld, 259/0.034, 427/0.0265, 889/0.0183 775/24 = 313 kcmil		1/2	1.25	1.36	0.18	0.93	1/2	71	Red
54115UF06	350	350 Navy		3/8	1.25	1.36	0.18	0.93	1/2	71			
54115UF					1/2	1.25	1.36	0.18	0.93	1/2	71		
54183UF					5/8	1.58	1.36	0.18	0.93	5/8	71		
58174UF	–		350 Weld, 259/0.0368, 427/0.0285, 703/0.0224, 889/0.0201		1/2	1.25	1.61	0.22	1.09	1/2	76	Blue	
54116UF	400	400 Navy		1/2	1.25	1.41	0.17	0.96	1/2	76			
54185UF					5/8	1.58	1.41	0.17	0.96	5/8	76		
58177UF06			400 Weld 925/24 = 373 kcmil		3/8	1.31	1.61	0.22	1.04	5/8	80	–	
58177UF					1/2	1.25	1.61	0.22	1.04	1/2	80		
54118UF	500	500 Navy			1/2	1.25	1.61	0.22	1.10	1/2	87	Brown	
54187UF					5/8	1.58	1.61	0.22	1.10	5/8	87		
58180UF	–		1100/24 = 444 kcmil, 450, 1127 / 450, 4522		5/8	1.58	1.75	0.24	1.20	1/2	94	Green	
54120UF	600	–			5/8	1.58	1.75	0.24	1.20	1/2	94		
54122UF	700	–			5/8	1.58	1.84	0.23	1.26	1/2	99	Pink	
58182UF	–		1325/24 = 535 kcmil		1/2	1.69	1.81	0.28	1.25	13/16	99		
58182UF			427/0.0342		5/8	1.58	1.81	0.28	1.25	5/8	99		
54123UF	750	600 Flex 427 Str.			5/8	1.58	1.94	0.27	1.33	5/8	106	–	
58184UF	–		1600/24 = 646 kcmil		5/8	1.58	1.94	0.27	1.33	5/8	106		
54124UF	800	800 Navy			5/8	1.58	2.01	0.27	1.38	5/8	107	Orange	
54126UF	900	1925/24 = 777 kcmil, 900 Navy			5/8	1.58	2.17	0.31	1.50	5/8	115	Yellow	
54128UF	1000	1000 Navy			5/8	1.58	2.27	0.30	1.55	5/8	125	–	

<sup>†</sup> Contact technical services for specific stranding listings. Tooling – see pages 104-127. Die selector chart – see pages 128-133.

# Compression connectors for copper conductor

## One-hole lugs – 90° Standard barrel 600 V to 35 kV



**Material** – High-conductivity wrought copper  
**Finish** – Electro tin plate



One-hole lugs – 90° Standard barrel 600 V to 35 kV

Diagrams	Cat. No.	Code (AWG or kcmil)	Wire size Flex class G, H, I, K, M*	Bolt size (in.)	Dimensions (in)					Die code	Die color	
					B	C	D	E	F			
	54104UB	#8	23 Navy	#10	0.50	0.39	0.08	0.25	7/32	21	Red	
	54130UB		#8 Weld	1/4	0.61	0.45	0.07	0.25	1/4	21		
	54131UB		37/24 = 14.9 kcmil	5/16	0.64	0.56	0.05	0.25	9/32	21		
	54132UB			3/8	0.64	0.56	0.05	0.25	9/32	21		
		54134UB	#6	30 Navy	#10	0.53	0.44	0.07	0.31	7/32	24	Blue
		54105UB		#6 Weld	1/4	0.53	0.44	0.07	0.31	7/32	24	
		54135UB		61/24 = 24.6 kcmil	5/16	0.67	0.60	0.07	0.31	5/16	24	
		54136UB		133/0.014	3/8	0.67	0.60	0.07	0.31	5/16	24	
		54138UB	#4	#4 Weld	#10	0.60	0.55	0.09	0.37	1/4	29	Gray
		54106UB		40–50 Navy	1/4	0.60	0.55	0.09	0.37	1/4	29	
54139UB			91/24 = 36.7 kcmil	5/16	0.66	0.61	0.07	0.37	5/16	29		
54140UB			133/0.0177	3/8	0.66	0.61	0.07	0.37	5/16	29		
256-30695-264UB			49/0.029	3/8	0.66	0.61	0.07	0.37	5/16	29		
54107UB		#2	60 Navy	1/4	0.65	0.59	0.11	0.41	1/4	33	Brown	
54142UB			125/24 = 50.4 kcmil	5/16	0.88	0.59	0.11	0.41	3/8	33		
54143UB			#3 Weld	3/8	0.80	0.59	0.11	0.41	3/8	33		
54145UB				1/2	1.08	0.75	0.08	0.41	1/2	33		
		54108UB	#1	75 Navy, #2 Weld	1/4	0.65	0.68	0.11	0.47	1/4	37	Green
	54147UB		150/24 = 60.5 kcmil	5/16	0.93	0.68	0.11	0.47	3/8	37		
	54148UB		175/24 = 70.6 kcmil	3/8	0.98	0.68	0.11	0.47	3/8	37		
	54150UB		133/0.0223	1/2	1.25	0.76	0.11	0.47	1/2	37		
	54152UB	1/0	100 Navy	1/4	0.65	0.75	0.13	0.52	1/4	42	Pink	
	54153UB		#1 Weld	5/16	0.88	0.75	0.13	0.52	3/8	42		
	54109UB		225/24 = 90.8 kcmil	3/8	0.93	0.75	0.13	0.52	3/8	42		
	54155UB		133/0.0254	1/2	1.25	0.75	0.13	0.52	1/2	42		
	54157UB	2/0	125 Navy	1/4	0.65	0.83	0.13	0.57	1/4	45	Black	
	54158UB		1/0 Weld	5/16	0.88	0.83	0.13	0.57	3/8	45		
	54110UB		275/24 = 111 kcmil	3/8	0.93	0.83	0.13	0.57	3/8	45		
	54160UB		427/0.0155, 133/0.0282	1/2	1.25	0.83	0.13	0.57	1/2	45		
	54162UB	3/0	150 Navy, 2/0 Weld	1/4	0.65	0.92	0.13	0.63	1/4	50	Orange	
	54163UB		325/24 = 131 kcmil	5/16	0.88	0.92	0.13	0.63	3/8	50		
	54111UB		133/0.0316, 259/0.0227	3/8	0.93	0.92	0.13	0.63	3/8	50		
	54165UB		427/0.0177	1/2	1.25	0.92	0.13	0.63	1/2	50		
	54167UB	4/0	200 Navy	1/4	0.65	1.03	0.14	0.70	1/4	54	Purple	
	54168UB		3/0 Weld	5/16	0.87	1.03	0.14	0.70	3/8	54		
	54112UB		450/24 = 182 kcmil	3/8	0.93	1.03	0.14	0.70	3/8	54		
	54170UB		703/0.0154	1/2	1.25	1.03	0.14	0.70	1/2	54		
	58161UB	-	4/0 Weld	1/4	0.78	1.25	0.15	0.79	3/8	62	Yellow	
	58162UB		550/24 = 222 kcmil	5/16	0.88	1.25	0.15	0.79	3/8	62		
	58163UB		133/0.0399	3/8	0.93	1.25	0.15	0.79	3/8	62		
	58165UB		259/0.0286	1/2	1.25	1.25	0.15	0.79	1/2	62		
	58166UB		637/0.0183	5/8	1.58	1.25	0.15	0.79	5/8	62		

\* Contact technical services for specific stranding listings. Tooling – see pages 104-127. Die selector chart – see pages 128-133.

## Compression connectors for copper conductor

One-hole lugs – 90° Standard barrel 600 V to 35 kV (continued)



**Material** – High-conductivity wrought copper

**Finish** – Electro tin plate



One-hole lugs – 90° Standard barrel 600 V to 35 kV

Diagrams	Cat. no.	Code (AWG or kcmil)	Wire size Flex class G, H, I, K, M <sup>†</sup>	Bolt size (in.)	Dimensions (in)					Die code	Die color
					B	C	D	E	F		
	54172UB	250	250 Navy	1/4	0.65	1.13	0.14	0.77	1/4	62	Yellow
	54173UB			5/16	0.88	1.13	0.14	0.77	3/8	62	
	54174UB			3/8	0.93	1.13	0.14	0.77	3/8	62	
	54113UB			1/2	1.25	1.13	0.14	0.77	1/2	62	
	58168UB	–	250 Weld, 650/24 = 262 kcmil, 259/0.0311, 703/0.0189	1/2	1.25	1.25	0.15	0.85	1/2	66	
	54178UB	300	300 Navy	5/16	0.88	1.25	0.15	0.85	3/8	66	
	54179UB			3/8	0.93	1.25	0.15	0.85	3/8	66	
	54114UB			1/2	1.25	1.25	0.15	0.85	1/2	66	
	54181UB			5/8	1.58	1.25	0.15	0.85	5/8	66	
		58171UB	–	300 Weld, 259/034, 427/0.0265, 889/0.0183 775/24 = 313 kcmil	1/2	1.25	1.36	0.18	0.93	1/2	71
256-30695-112UB		350	350 Navy	3/8	1.25	1.36	0.18	0.93	1/2	71	
54115UB				1/2	1.25	1.36	0.18	0.93	1/2	71	
54183UB				5/8	1.58	1.36	0.18	0.93	5/8	71	
58174UB		–	350 Weld, 259/0.0368, 427/0.0285, 703/0.0224, 889/0.0201	1/2	1.25	1.61	0.22	1.09	1/2	76	Blue
54116UB		400	400 Navy	1/2	1.25	1.41	0.17	0.96	1/2	76	
54185UB				5/8	1.58	1.41	0.17	0.96	5/8	76	
256-30695-1403UB		–	400 Weld, 925/24 = 373 kcmil 259/0.0393, 427/0.0306	3/8	1.31	1.61	0.22	1.04	5/8	80	
58177UB				1/2	1.25	1.61	0.22	1.04	1/2	80	
		54118UB	500	500 Navy	1/2	1.25	1.61	0.22	1.10	1/2	87
	54187UB			5/8	1.58	1.61	0.22	1.10	5/8	87	
	58180UB	–	1100/24 = 444 kcmil, 450, 1127 450, 4522	5/8	1.58	1.75	0.24	1.20	5/8	94	Green
	54120UB	600	–	5/8	1.58	1.75	0.24	1.20	5/8	94	
	54122UB	700	–	5/8	1.58	1.84	0.23	1.26	5/8	99	
	256-30695-840UB	–	1325/24 = 535 kcmil 500 Flex, 427/0.0342, 259, 1125, 5054	1/2	1.69	1.81	0.28	1.25	1 7/16	99	Pink
	58182UB			5/8	1.58	1.81	0.28	1.25	5/8	99	
	54123UB	750	600 Flex 427	5/8	1.58	1.94	0.27	1.33	5/8	106	Black
	58184UB	–	1600/24 = 646 kcmil	5/8	1.58	1.94	0.27	1.33	5/8	106	
	54124UB	800	800 Navy	5/8	1.58	2.01	0.27	1.38	5/8	107	Orange
	54126UB	900	1925/24 = 777 kcmil, 900 Navy	5/8	1.58	2.17	0.31	1.50	5/8	115	Yellow
	54128UB	1000	1000 Navy	5/8	1.58	2.27	0.30	1.55	5/8	125	–

<sup>†</sup> Contact technical services for specific stranding listings. Tooling – see pages 104-127. Die selector chart – see pages 128-133.