



Quick2Clamp

MADE FOR REAL[®]

Bundling and Securing

Clamps

Ratchet P-Clamps

Quick2Clamp Inline Ratchet P-Clamps

Quick2Clamp offers ultra-fast installation and versatility for managing flexible conduit, tubing and cables. The built-in strut mount attaches with a simple twist. A one-piece design makes it simple to install. The robust, adjustable clamp closes by hand to the desired diameter. A release feature allows easy and nondestructive maintenance simply by using a flat-head screwdriver. In this way, the clamp can be reused or serviced without removing it from the strut.

Features and Benefits

- Clamp and mount combination means no extra hardware is needed, for time-saving, toolless, one-handed installation.
- Three size ranges handle diameters from 0.5" to 2", reducing part inventory.
- Clamp saddle provides additional attachment option using a cable tie.
- Impact modified, heat and UV stabilized PA66 provides long-term durability, indoors and out.

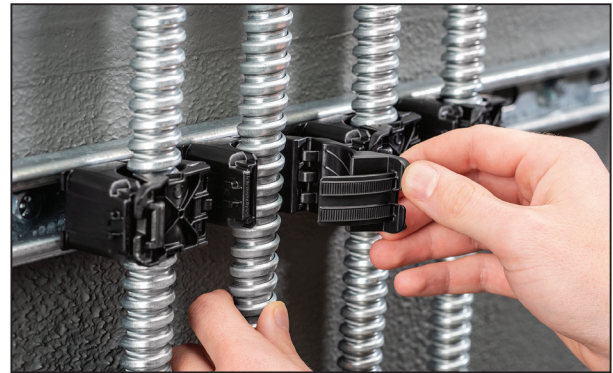

MATERIAL	Polyamide 6.6 high impact modified, heat and UV stabilized (PA66HIRHSUV)
Operating Temperature	-40°F to +221°F (-40°C to +105°C)
Color	Black (BK)

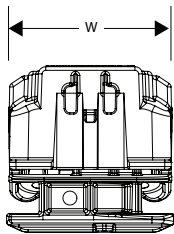

PART NO.	TYPE	Min. Bundle Diameter in. (mm)	Max. Bundle Diameter in. (mm)	Strut Profile	Width (W) in. (mm)	Pkg. Qty.
156-03001*	IRCBSTRUT	0.5 (12.7)	0.8 (19.5)	1-5/8 Strut Attachment	1.4 (34.8)	25
156-03000*		0.5 (12.7)	0.8 (19.5)	1-5/8 Strut Attachment	1.4 (34.8)	200
156-03003*	IRCCSTRUT	0.8 (19.4)	1.4 (36.0)	1-5/8 Strut Attachment	1.4 (34.8)	25
156-03002*		0.8 (19.4)	1.4 (36.0)	1-5/8 Strut Attachment	1.4 (34.8)	200
156-03005*	IRCDSTRUT	1.4 (36.0)	2.0 (51.0)	1-5/8 Strut Attachment	1.4 (34.8)	25
156-03004*		1.4 (36.0)	2.0 (51.0)	1-5/8 Strut Attachment	1.4 (34.8)	200

Dimensions are approximate and subject to technical changes. Use Part No. for ordering and Type for specification purposes.

Load Rating: 17 lbs, Safety Factor: 3

Pull Force Rating: 50 lbs

*This product meets UL standards.



UL2239 Conduit & Cable Hanger

Installation Guide

STEP 1: Insert clamp base into strut and rotate 90 degrees to lock in place.



STEP 2: With conduit, cable or tubing in place, close clamp by pushing down until desired compression is achieved.**



**Optional Tension Tabs and application tool may be used to ensure exact, required clamping force.

Sizes and Types of Conduit, Cable or Tubing

PRODUCT	Flexible Conduit (FMC)	Liquid-Tight (LFMC and LFNC-B)	Cables, Tubing, Bundles
	Trade Size	Trade Size	Min/Max Diameter
IRCBSTRUT	3/8"	3/8"	1/2" to 3/4"
IRCCSTRUT	1/2", 3/4", 1"	1/2", 3/4", 1"	3/4" to 1-3/8"
IRCDSTRUT	1-1/4" and 1-1/2"	1-1/4" and 1-1/2"	1-3/8" to 2"

Note: This product is not intended to support rigid conduit.



HellermannTyton North American Corporate Headquarters

7930 N. Faulkner Rd, PO Box 245017
Milwaukee, WI 53224-9517
Phone: (414) 355-1130, (800) 537-1512
Fax: (414) 355-7341, (800) 848-9866
email: corp@htamericas.com
www.hellermann.tyton.com

IATF 16949, AS9100, ISO 9001 and ISO14001 certified

HellermannTyton Canada

Unit #4, 205 Industrial Parkway North
Aurora, Ontario L4G 4C4 Canada
Phone: (800) 661-2461
Fax: (800) 390-3904
email: sales@hellermanntyton.ca

HellermannTyton Mexico

Anillo Periferico Sur 7980 Edificio 6A
Parque Industrial Tecnologico II
Santa Maria Tequepexpan
Tlaquepaque, Jalisco, Mexico 45601
Phone: 011-52-33-3-133-9880
Fax: 011-52-33-3-133-9861
email: info@htamericas.com.mx

ISO 9001 certified

Warranty Policy – HellermannTyton products are warranted to be free from defects in material and workmanship at the time sold by us; but our obligation under this warranty and that of the seller is limited to the replacement of the product, and neither we nor the seller are bound by any other warranty, expressed, implied or statutory. Under no circumstances are we or the seller liable for any loss, damage, expenses or consequential damages of any kind arising out of the use or inability to use these products. All are sold with the understanding that the user will test them in actual use and determine their adaptability for the intended uses.